

ALPOLIC®/HD

MATERIALS

MITSUBISHI PLASTICS COMPOSITES AMERICA, INC.

architectural - heavy duty

ALPOLIC®/HD aluminum composite materials are manufactured with either a polyethylene or mineral filled fire resistant core. This product is produced with 0.032" top and bottom aluminum skins for added rigidity and strength. Any of our fluoropolymer paint finishes including solid, mica, metallic, and prismatic can be applied.

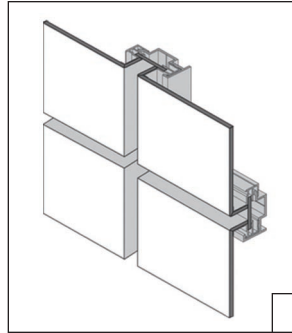

CONSTRUCTION INFORMATION

PROJECT: LivN Nsidout Sport & Wellnes Center

LOCATION: South Carolina

ARCHITECT: McMillan Pazdan Smith

PRODUCT: ALPOLIC® Mica



GENERAL INFORMATION

ALPOLIC®/HD panels provide additional yield and tensile strength vs. standard ALPOLIC panels along with over 5 times the flexural elasticity strength. For applications requiring heavy duty strength and exterior performance, ALPOLIC®/HD panels are the answer. These 4mm or 6mm panels are custom manufactured and not a stocked product. Additional product lead time and minimum order requirements may apply.

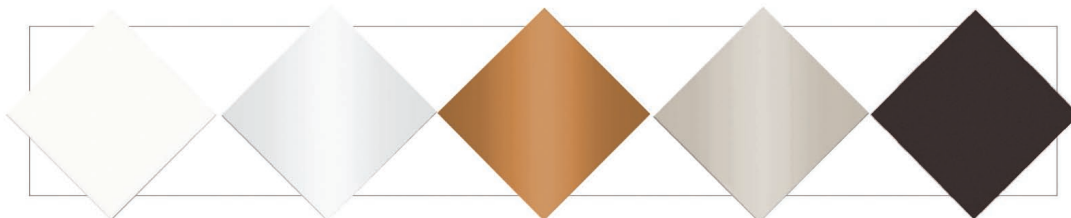

BONE WHITE
4-4BNT-G30

MICA PLATINUM
4-4OPT-G50

DARK COPPER
METALLIC
4-4DCX-G30

MICA CHAMPAGNE
4-4MCU-G30

BRONZE
4-4JBR-G30

ALPOLIC®

heavy duty

INTERIOR AND EXTERIOR SURFACING
INTERIOR AND EXTERIOR SIGNAGE

SURFACE TREATMENT

ALPOLIC®/HD panels are available with a fluoropolymer paint system that features excellent durability and weathering for architectural needs. All ALPOLIC® Heavy Duty products are custom manufactured.

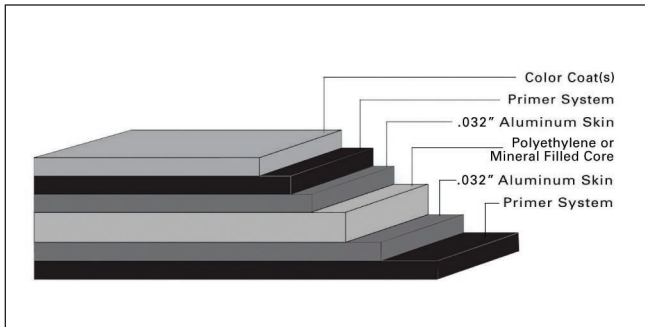

STANDARD PANEL SIZE

Typical widths are 50" (1270mm) and 62" (1575mm) and lengths of 146" (3708mm) and 196" (4978mm). Panels can be manufactured in 4mm or 6mm thickness. Standard crate pieces will depend on thickness and core selected. As this product is custom manufactured, other widths, lengths, and thicknesses can be produced. Please contact ALPOLIC® Customer Service for additional information.

FINISH TOLERANCE

Color (Hunter L,a,b): DE 1.0 max from standard, solid
DE 2.5 max for mica, metallic,
and prismatic
Gloss: Nominal +/- 10 units

PRODUCT TOLERANCE

Width: ± 0.08" (2mm)
Length: ± 0.16" (4mm)
Thickness: 4mm ± 0.008" (0.2mm)
6mm ± 0.012" (0.3mm)
Bow: maximum 0.5% of length
and/or width
Squareness: maximum 0.2" (5mm)
Peel Strength: >22 in lb/in (ASTM D1781)

ALPOLIC® material is trimmed and squared with cut edges to offer the best panel edge conditions in the industry.

FIRE PERFORMANCE

ALPOLIC® panels with have been tested by independent testing laboratories using nationally recognized tests.

PRODUCT PERFORMANCE

	ALPOLIC/fr HD	ALPOLIC/fr
Yield Strength, E8 (psi):	8,818	6,344
Tensile Strength, E8 (psi):	9,990	7,126
Elongation, E8 (%):	5.9	5.0
Flexural Modulus of Elasticity, C393 (psi):	31,410,471	5,770,000

*Above are typical values

WARRANTY

Standard panel warranty: 10 Year
Finish warranty: 30 Year*

Call ALPOLIC® Customer Service for exclusions and warranty details. *30 year warranty only applies to standard architectural painted finishes.

PRODUCT NOTES

- Minimum order quantities may apply.
- Additional product lead time may be required.
- Panels should be stored flat in a dry, indoor environment.
- Fabricate panels at temperatures above 55°F.
- Protective film should be removed from panels soon after installation.
- Please refer to appropriate Fabrication Manual for routing and fabrication recommendations.
- For best color consistency, ALPOLIC® recommends ordering all required mica, metallic and prismatic paint finish panels at one time and maintaining consistent panel orientation during installation.

FOR TECHNICAL INFORMATION, PLEASE
CALL 1.800.422.7270

U.S. HEADQUARTERS

MITSUBISHI PLASTICS COMPOSITES AMERICA, INC.

401 Volvo Parkway, Chesapeake, VA 23320

Telephone: 800-422-7270, Facsimile: 757-436-1896

www.alpolic-northamerica.com e-mail: info@alpolic.com