

ALPOLIC®

MATERIALS

MITSUBISHI PLASTICS COMPOSITES AMERICA, INC.

program – polyester

ALPOLIC® Polyester finish aluminum composite materials offer you a cost effective material for your interior, signage, and canopy applications. Custom color options are virtually unlimited in the polyester finish.

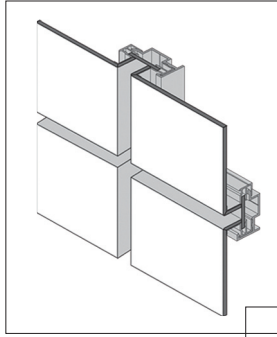

CONSTRUCTION INFORMATION

PROJECT: 7-Eleven

LOCATION: Virginia Beach, VA

PRODUCT: ALPOLIC® SWT Grey/White



GENERAL INFORMATION

ALPOLIC® program Polyester panels are designed to have optimal panel strength and integrity but more cost effective for some program/application as it utilizes a lower cost and performance polyester finish versus ALPOLIC® standard FEVE fluorocarbon finish. Designed for signage and base material for vinyl graphics as well as interior applications.

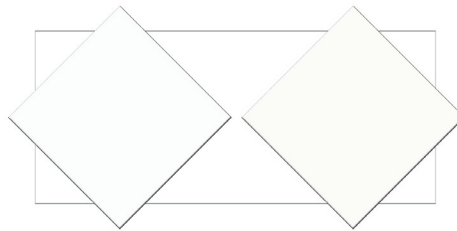

SIW WHITE
3-3SIW-G30

SWT Grey/White
3-3SWT-G35

SURFACE TREATMENT

ALPOLIC® program Polyester color panels are finished with a polyester paint system and utilize a traditional polyethylene core. Available stock colors include SIW White and SWT Gray/White. Custom colors including mica and metallic can be produced.

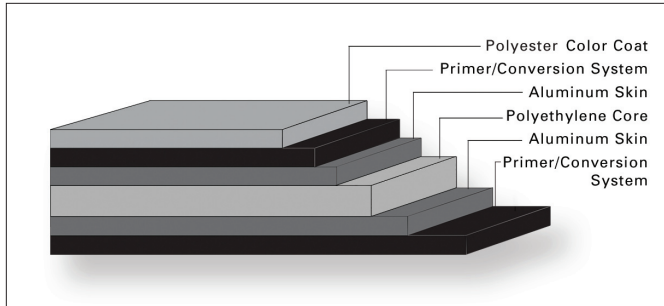

STANDARD PANEL SIZE

Standard stock sizes and thickness vary by product program. Please contact Customer Service for stock sizes. Standard crate is 75 pieces for 3mm and 50 for 4mm. Custom thickness, widths, lengths are available, along with a fire resistant core. Please contact Customer Service for current available stock and additional information.

FINISH TOLERANCE

Color: DE 1.0 max from standard
Gloss: Nominal +/-10 units

PRODUCT TOLERANCE

Width: ± 0.08" (2mm)
Length: ± 0.16" (4mm)
Thickness: 3mm: ± 0.008" (0.2mm)
4mm: ± 0.008" (0.2mm)
6mm: ± 0.012" (0.3mm)
Bow: maximum 0.5% of length and/or width
Squareness: maximum 0.2" (5mm)

ALPOLIC® material is trimmed and squared with cut edges to offer the best panel edge conditions in the industry.

FIRE PERFORMANCE

Standard ALPOLIC® program Polyester finish panels with a polyethylene core have been tested by independent testing laboratories using nationally recognized tests.

This material meets all requirements of the International Building Code for combustible construction:

IBC Listed for all .020/.020 products
UL Listed

Please visit www.alpolic-northamerica.com or call technical support for complete report listings and additional information.

WARRANTY

Standard panel warranty: 10 Year
Finish warranty: None

Call ALPOLIC® Customer Service for exclusions and warranty details.

PRODUCT NOTES

- Panels should be stored flat in a dry, indoor environment.
- Fabricate panels at temperatures above 55°F.
- Protective film should be removed from panels soon after installation.
- Please refer to ALPOLIC® Painted ACM Fabrication Manual for routing and fabrication recommendations.
- Crating fees apply to orders for less than standard piece crate.

**FOR TECHNICAL INFORMATION, PLEASE
CALL 1.800.422.7270**

U.S. HEADQUARTERS
MITSUBISHI PLASTICS COMPOSITES AMERICA, INC.

401 Volvo Parkway, Chesapeake, VA 23320
Telephone: 800-422-7270, Facsimile: 757-436-1896
www.alpolic-northamerica.com e-mail: info@alpolic.com