

# ALPOLIC®/fr

## MATERIALS

MITSUBISHI PLASTICS COMPOSITES AMERICA, INC.

fr LT – anodized

ALPOLIC®/fr LT anodized aluminum composite material (ACM) panels for interior applications is an exciting and new finish to the ALPOLIC®/fr LT series. A world of possibilities for design and application.

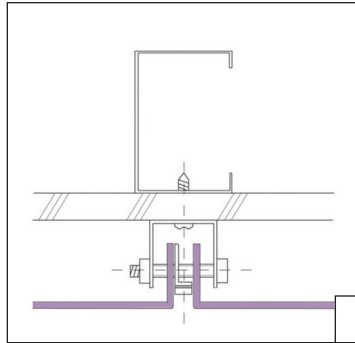

### CONSTRUCTION INFORMATION

PROJECT: Bashamichi Metro Station

LOCATION: Yokohama, Japan

ARCHITECT: Hiroshi Naitou

PRODUCT: ALPOLIC®/fr LT



### GENERAL INFORMATION

ALPOLIC®/fr LT is the material of the future. This world-class ACM made with thin aluminum skins and a fire resistant core is not only highly durable, it's also extremely lightweight, making it ideal for cladding interior walls, ceilings, columns, and displays.

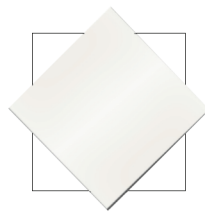

*THIN CLEAR ANODIZED*  
3-1C1

# ALPOLIC®/fr LT anodized

INTERIOR SURFACING  
INTERIOR SIGNAGE

## SURFACE TREATMENT

ALPOLIC®/fr LT Anodized material is a sandwiched aluminum skinned composite panel with a thin 0.425mils anodized finish on the top side. Available finish is Clear Anodized.

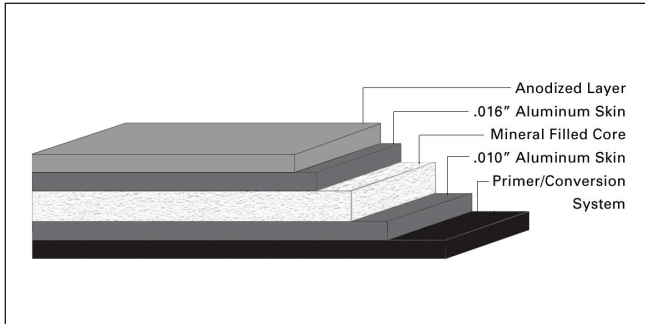

## STANDARD PANEL SIZE

Standard size is 48" x 96" (1219mm x 2438mm). Panels are available in 3mm thickness. Standard crate is 50 pieces. Custom length, thickness and a standard polyethylene core available. Please contact ALPOLIC® Customer Service for additional information.

## FINISH TOLERANCE

Color: DE 5.0 (CMC) variation within one lot\*  
Gloss: Nominal +/- 10 units  
\*Please note that Anodized panels can not be color controlled as tightly as painted panels and some color variation should be expected.

## PRODUCT TOLERANCE

Width: ± 0.08" (2mm)  
Length: ± 0.16" (4mm)  
Thickness: 4mm ± 0.008" (0.2mm)  
6mm ± 0.012" (0.3mm)  
Bow: maximum 0.5% of length and/or width  
Squareness: maximum 0.2" (5mm)

ALPOLIC® material is trimmed and squared with cut edges to offer the best panel edge conditions in the industry.

## FIRE PERFORMANCE

Fire resistant ALPOLIC®/fr LT Anodized panels with a mineral filled core have been tested by independent testing laboratories using nationally recognized tests.

This material meets all requirements of the International Building Code for applications requiring a Class A Fire Rating:

IBC Listed

Please visit [www.alpolic-northamerica.com](http://www.alpolic-northamerica.com) or call technical support for complete report listings and additional information.

## WARRANTY

Standard panel warranty: 5 Year  
Finish warranty: None  
Call ALPOLIC® Customer Service for exclusions and warranty details.

## PRODUCT NOTES

- Panels should be stored flat in a dry, indoor environment.
- Fabricate panels at temperatures above 55°F.
- Protective film should be removed from panels soon after installation.
- Please refer to ALPOLIC®/fr LT Fabrication Manual for routing and fabrication recommendations.
- Crating fees apply to orders for less than standard piece crate.

FOR TECHNICAL INFORMATION, PLEASE  
CALL 1.800.422.7270

### U.S. HEADQUARTERS

 MITSUBISHI PLASTICS COMPOSITES AMERICA, INC.

401 Volvo Parkway, Chesapeake, VA 23320

Telephone: 800-422-7270 Facsimile: 757-436-1896

[www.alpolic-northamerica.com](http://www.alpolic-northamerica.com) e-mail: [info@alpolic.com](mailto:info@alpolic.com)